

PLAN

NOTES:  
 6X6-W2.9xW2.9 WWF CAGE  
 W/ #4 U BARS AROUND OPENING  
 (4) 5/8" LIFTING INSERTS  
 APPROXIMATE WEIGHT = 3865 LBS EA.

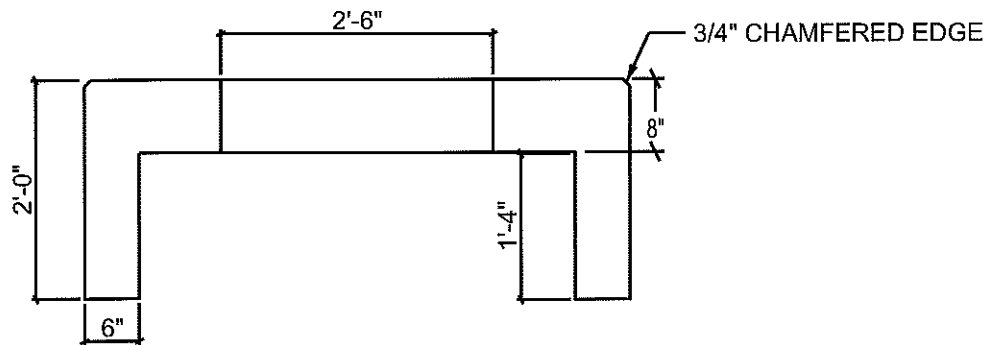

SECTION

| REBAR & MESH |      |         |      |            |        |
|--------------|------|---------|------|------------|--------|
| BAR#         | MARK | LENGTHS |      |            |        |
|              |      | QTY.    | BEND | LENGTH     | WEIGHT |
| #4           |      | 2       |      | 2'X1'2"X2' |        |
| #4           |      | 2       |      | 3'         |        |

|   |   |                  |
|---|---|------------------|
|   | 1122 BRADWAY ROAD,<br>NORTH POLE, AK.99705<br>PH: (907) 488-9763<br>FAX: (907) 488-8300 |                  |
|   | SCALE: NO SCALE   | DRAWN BY: T.E.C. |
| DATE 1/22/2010                            | REVISED: 2/19/2010  |                  |
| <b>UM1-1D/SUM1-D 56"X60"X24" (8" TOP)</b> |   |                  |